

Garden Gate Closer GTS 120/170

Mounting example type 5 - special

Direct gate and wall mounting on gates with centrally located door hinges



I. Check material and tool list

Your garden gate closer is delivered already assembled. Your product also includes two aluminium brackets with different side lengths, 4 tapping screws and 2 cap nuts.

WARNING: The garden gate closer is **preloaded!** The preloading safety should **not be removed before insertion!** Due to preloading the threaded rods of the gate closer are skewed. They will adjust during assembly.

- 1 garden gate closer GTS 120/170
- 1 aluminium bracket (bracket 1): 60, 80 or 100 mm
- 1 aluminium bracket (bracket 2): 30 mm
- 2 cap nuts M6
- 4 tapping screws 4,8 x 19 mm



You will need a **cordless screwdriver** with a **4.2 mm** and a **6 mm metal drill** and a **cross slot (Phillips) screwdriver** (PH2) for installation. Furthermore, you need a **spirit level**, **measuring tape**, **pen** and two **no.10 fork wrenches** as well as an **impact drill**, and **suitable dowels and screws** for your type of masonry, a **cone drill** and a **10 mm socket wrench**.

II. Determine type of mounting

The following mounting example shows a special mounting situation of **mounting type 5**, that is the **mounting on gates with door hinges installed at the wall**. In this special variant, the gate closer will not be installed with the enclosed bracket 2 but directly onto the gate. In our specific measures we use **bracket 1** size **60 mm**. For different situations, you may eventually need a longer (80 or 100 mm) bracket.

All sorts of mounting brackets and different types of mounting instructions are available on our website:
<https://gardengatecloser.com>

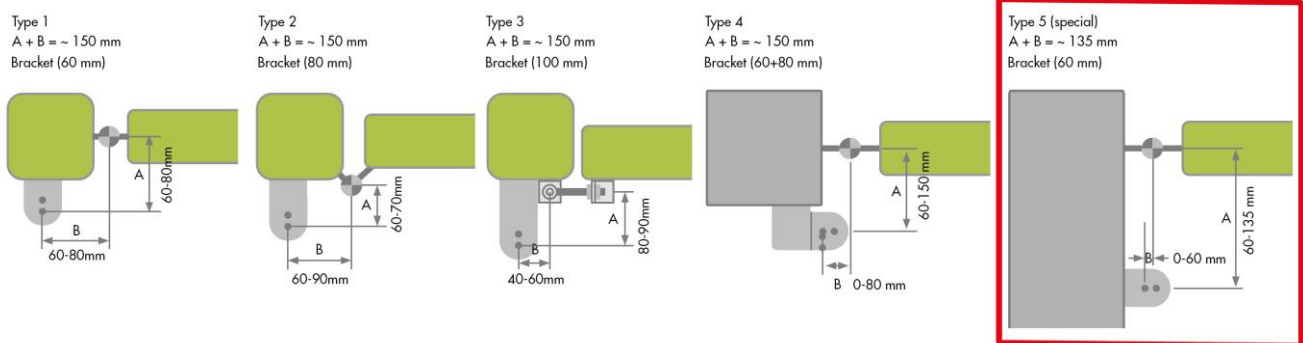

Using the following **QR-Code**, you can also watch this and all other mounting types on Youtube vvideo
<https://youtu.be/9qt9OIPX2HI> (german video with english subtitles):



Assembly Type 5 Special



All other types of assembly

III. 6 steps for successful mounting

1. Determine mounting position of gate closer
2. Measure bracket 1
3. Check piston stroke
4. Mount bracket 1
5. Determine mounting position on gate and prepare gate
6. Insert and tighten garden gate closer

Step 1: Determine mounting position of garden gate closer

First, you need to determine the position of the gate closer. It can be positioned at the top of the gate, in the middle or at the bottom. It is important that it is **mounted levelled**! As well, the two brackets (bracket 1 and bracket 2) need to find sufficient hold on the wall and on the gate respectively. The larger bracket (bracket 1) is to be mounted on the post. The smaller bracket (bracket 2) won't be used in this special mounting variant!

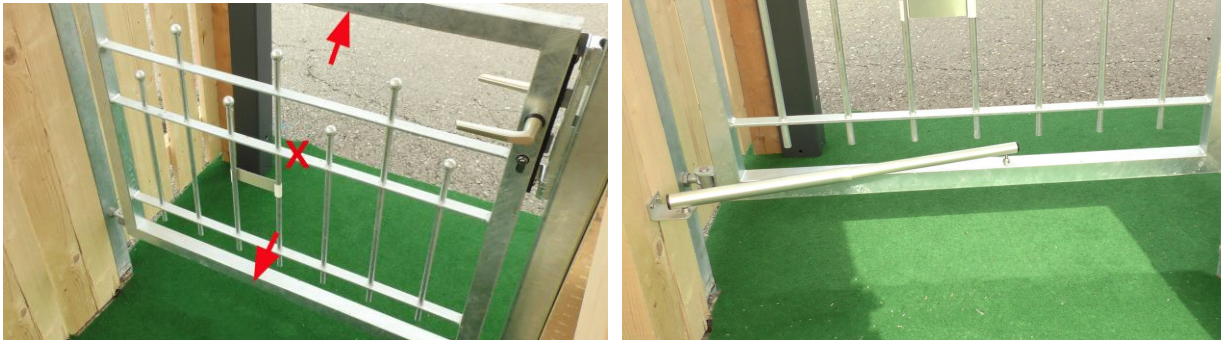

Step 2: Measure bracket 1 wall-sided

After having positioned the gate closer correctly, check the distance of the gate's pivot point (located in the middle of the hinges) and the pivot point of the closer (chosen mounting hole of bracket 1). For measuring use the larger bracket (**bracket 1**).

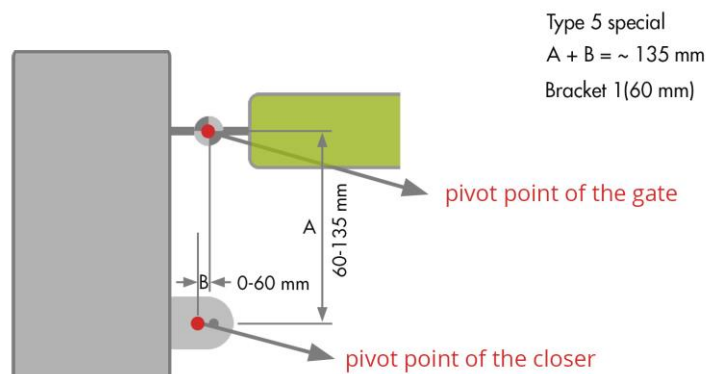

The **sum of the two distances A and B** in this special case should **not exceed 135 mm**, and also should **not be less** than 125 mm either. However, if the sum of the distances is bigger than 135 mm, the gate can only be opened a little **less than 90°** at worst.

In this special case, distance B can be „0“. Consequently bracket 1 will be mounted in such a fashion, that the distance of the mounting hole of bracket 1 and the centre of the hinges amounts to 135 mm (see plan: A = 135 mm, B = 0 mm).



Note: In step 3 the exact positioning of the bracket will be checked again and possibly fine-tuned.

Step 3: Check piston stroke

This step is to check the measured position of bracket 1 and possibly change it slightly, so that the optimized closing performance can be guaranteed. If you choose to proceed with the measurements done before you can skip this step.

However, we strongly advise you to take your time for this verification.

To verify the mounting positions fix bracket 1 provisionally **at the position as measured before** and install the gate closer in the mounting hole as chosen before. **Close the gate** and mark the position of the bolt on the frame of the gate (mark 1). Then **open the gate** and mark again the position of the bolt on the frame (mark 2).

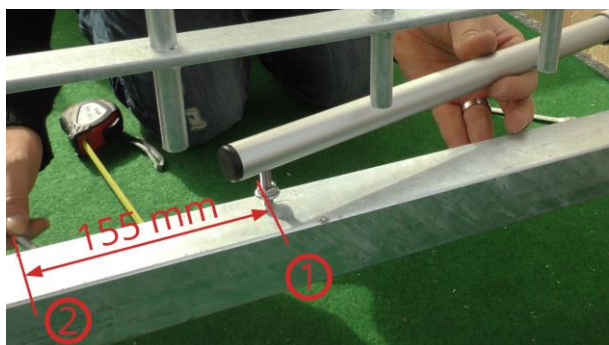

If the **distance between the two marks** amounts to **about 155 mm**, the position of the bracket is **optimal**. If the distance is a bit less, increase distance B a bit. If the distance is bigger than 155 mm, decrease distance B or choose another mounting hole.

Note: The gate closer can be installed in any mounting hole of the bracket, as long as the distance is correct. If you use a larger bracket than 60 mm (**80 or 100 mm**) we advise you to choose one of the **centred mounting holes** so you can possibly fine-tune the gate closer later.

Step 4: Mount bracket 1

If like in this example, the distance between the open gate and the wall is practically zero, we advise you to position the gate closer plus bracket in-between the decorative elements of the gate (see picture). The reason for this is, that if the open gate touches the bracket or the closer, it cannot be opened fully (90°). In case that it is not possible to mount the closer in-between the gate elements, you can also mount it above the gate so that the full opening is guaranteed.

In our example, the position of the bracket is also measured vertically, so that the bracket plus closer and cap nuts fit in-between the decorative elements of the gate.

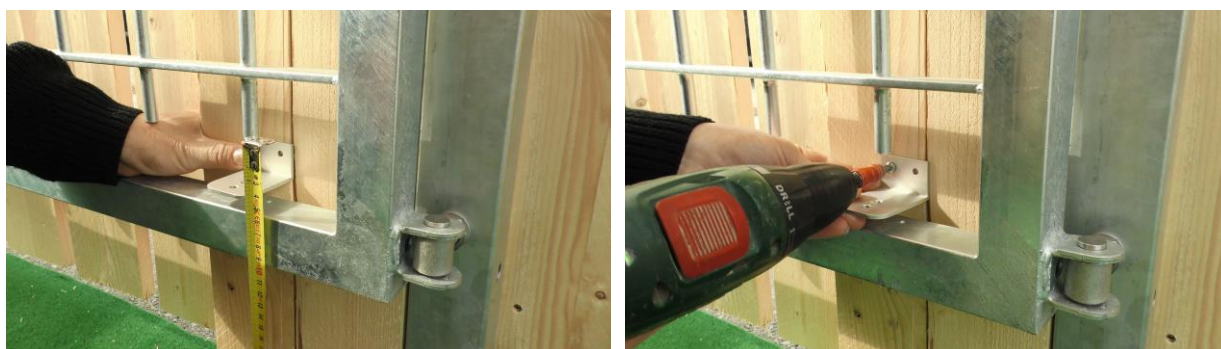

After having measured the correct position of bracket 1, fix it using suitable mounting material (e.g. screws or dowels and screws). In our example the two screws enclosed are sufficient.

Attention: Make sure that the bracket lies flat upon the wall. In the case of brick or stone walls, level the ground before mounting!

Step 5: Determine mounting position on gate and prepare gate

Having positioned and fixed the first bracket (bracket 1) correctly, you've already done the biggest part of the mounting! Now, the mounting position of the closer on the gate will be determined. Remember: The second bracket (**bracket 2**) will not be used, because the closer will be installed directly on the gate. The distance between the mounting hole on bracket 1 and the mounting hole of the closer on the door must be between **540 mm** and **545 mm**. **Exact measurement is essential here!**

As an alternative you can remove the preloading safety pin and measure the necessary distance at site. Do not forget to subtract 10 mm for preloading. But be careful: If this distance is too small, the gate will only open a little less than 90°. If it is too big, the gate won't close entirely.



Having measured the distance correctly, unhook the gate and transfer the mounting position to the bottom of the frame. Then drill the frame entirely using a **6 mm metal drill**. Make sure that the drilling is done straight in line. As a next step, widen the drilling hole at the bottom up to 12 – 14 mm using a cone drill. This is necessary, so that the **10 mm socket wrench** can be placed.



Attention: If you adjust the position of bracket 1 later, bracket 2 must be re-positioned as well to ensure the correct hole-to-hole distance.

Step 6: Insert and tighten garden gate closer

Now, put the gate back to its original position. For mounting the gate closer the **thicker end** of the closer must be put into **bracket 1**. The **slimmer end** must be mounted into the drilling as done in step 5.

Finally, the gate closer is fixed using the cap nuts. Therefore screw on and tighten the cap nuts using the locknuts. In this step the nuts have to be tightened in such a fashion, so that the **threaded rods** are straightened and stand in **right angles** to the mounting bracket or the gate respectively.

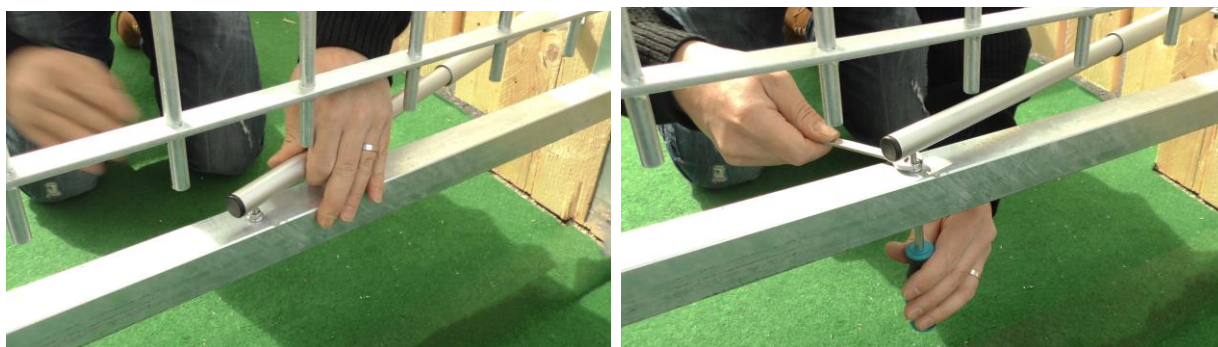

Note: In most cases, the pre-loading security bolt loosens by itself during this procedure. In case that the bolt remains, carefully move the gate just a few millimetres towards its opening direction!



You've done it. We hope you enjoy your new Garden Gate Closer!

If you have any further questions about the assembly, do not hesitate to contact us via email office@gardengatecloser.com or via our **WhatsApp service +43 664 881 89 781!**

Also have a look at our installation videos on our homepage! The most frequent questions can be answered immediately.

Your gardengatecloser.com team

PS: If you are satisfied with our gate closer your **positive review** on our website or on Amazon would make us very happy!